

# Clamshell Buckets



## KG 05-2 Series



### Features

- Buckets exchangeable within the entire series
- Hydraulic rotator with endless rotation
- Buckets entirely made from high-strength fine-grained steel (450 HB)
- Forged 2-hole bolt-on teeth
- Horizontally mounted hydraulic cylinder for additional protection
- Hose protection bracket for hydraulic rotator connections
- Mechanical opening stops

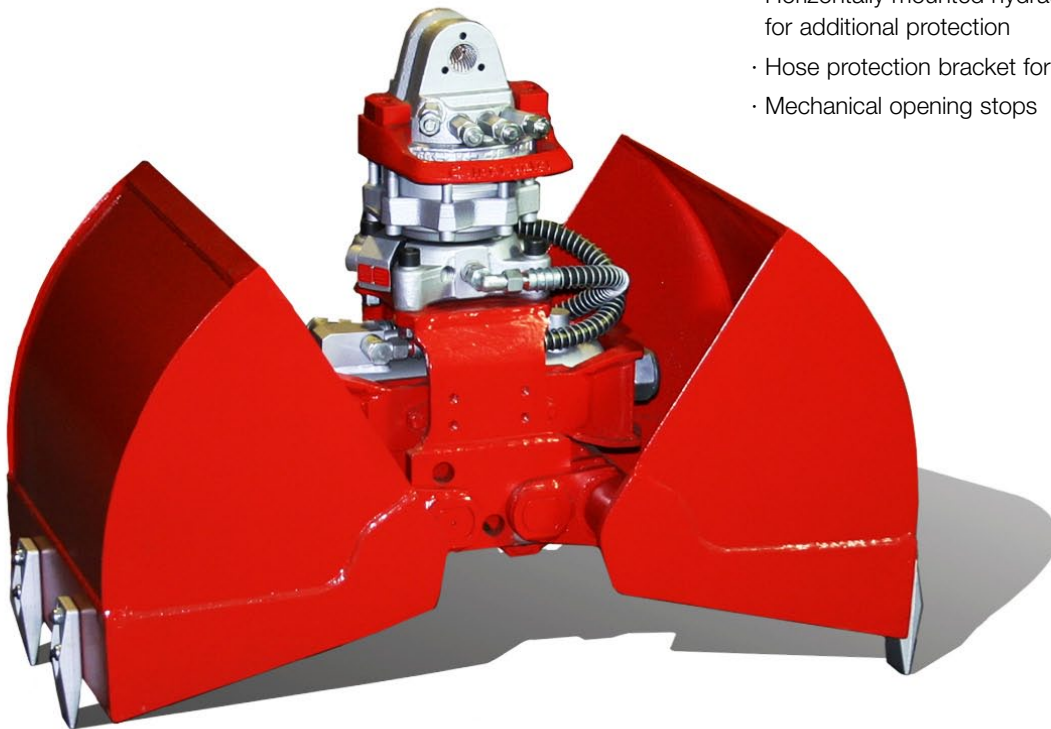

### Range of use: mobile cranes and mini excavators

Versatile civil engineering grab for typical hydraulic carrier applications, for instance:

- Excavation and digging of undisturbed ground
- Digging ditches and cable trenches
- Handling soil, gravel and sand

### Available accessories and tools

- Rotator with integrated grab pressure limitation
- Hose sets and mounting brackets for all well-known excavator and loader crane brands
- Suspension link with swing brake
- Load hook
- Custom-built buckets
- Custom equipment upon request

# Technical Specifications

## KG 05-2 Series

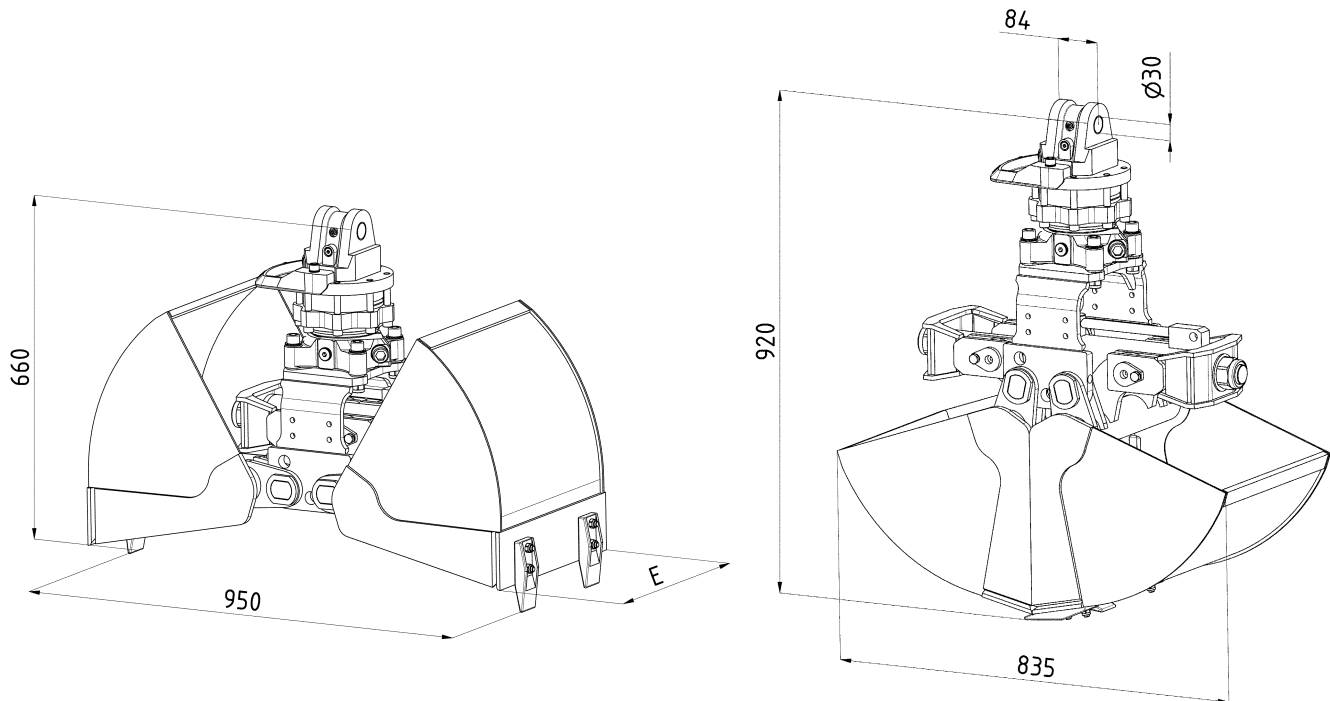

Type	Capacity l	Weight kg	Width of cut E mm	Teeth (option) pieces
KG 05-2-300	60	145	300	3
KG 05-2-400	80	155	400	3
KG 05-2-500	100	165	500	5

Other sizes and series available upon request · Subject to technical modifications!

- Maximum load capacity:** grab: 1 t/rotator: 4.5t
- Bulk density:** up to 2t/m<sup>3</sup>
- Maximum working pressure:** grab and turning function 250bar
- Maximum closing force:** 24 kN
- Connections:** turning: 12L/grabbing: 12L
- Capacity:** turning: min. 12l/min, grabbing: max. 25l/min
- Excavator weight category:** 1-5t

